

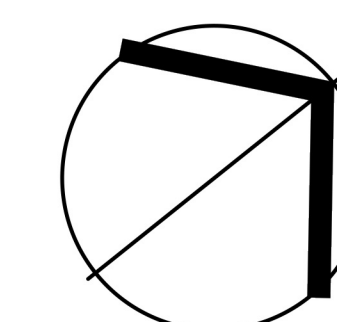

## LEGEND:

1. PLAZA / SHADE
2. FREE PLAY
3. JUNIOR PLAY
4. SENIOR PLAY
5. SAND
6. FITNESS AREA
7. FITNESS TRAIL
8. HALF COURT BASKETBALL





user: Cathy/Jin file: P:\PROJECTS\2813 - Frontenac Forest\1 - Design Phase\CAD\Frontenac\_2025-03-03\CGLA - SWM Plans.dwg plot: Mar 27, 2025 - 10:28am

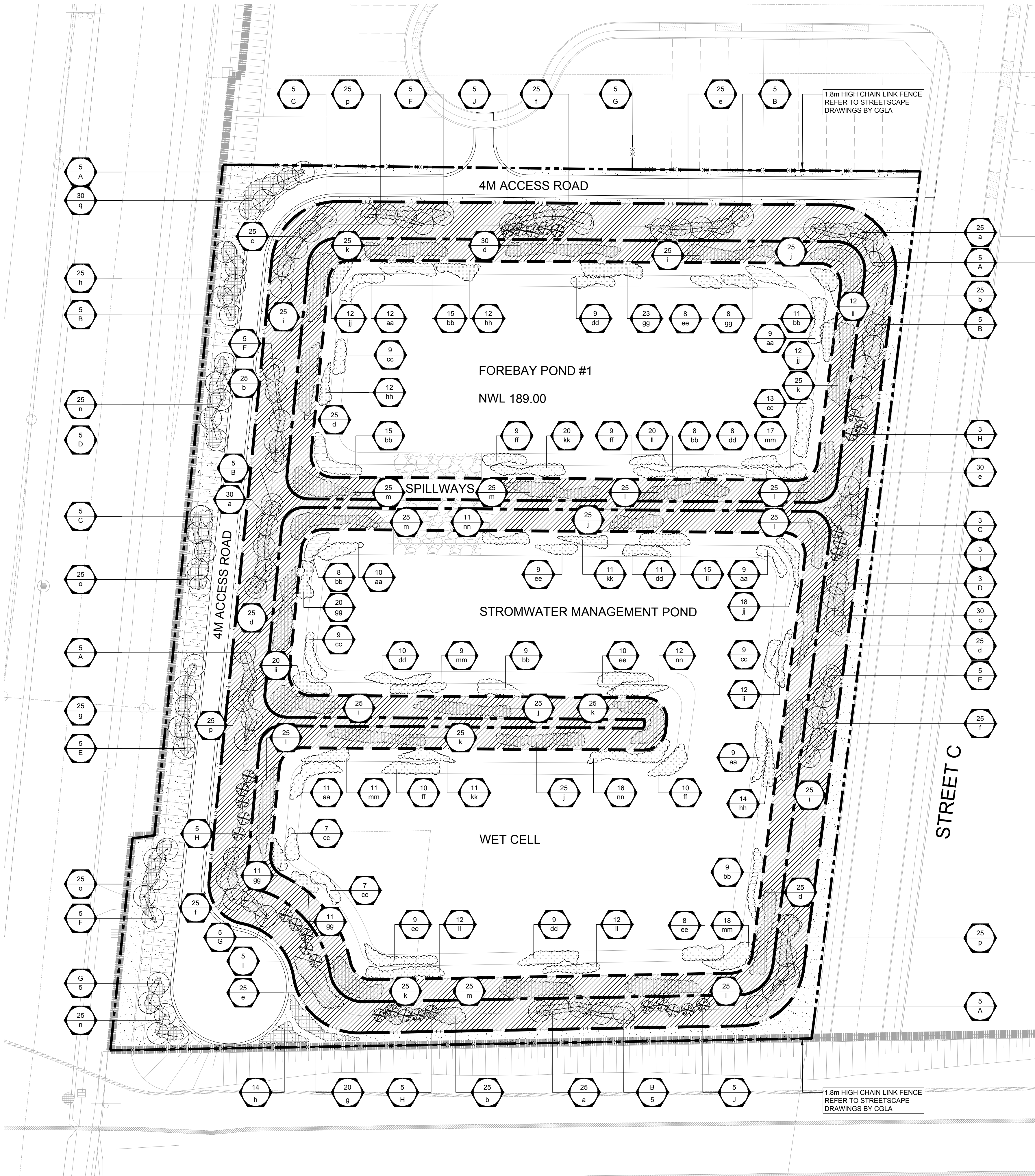

MASTER PLANT LIST

KEY	TOTAL	BOTANICAL NAME	COMMON NAME	HEIGHT (mm)	SPREAD (mm)	CALIPER (mm)	COND.	REMARKS
DECIDUOUS TREES								
A	20	ACER SACCHARINUM	SILVER MAPLE	1500-3000		30-60	B&B	
B	25	FRAXINUS PENNSYLVANICA	GREEN ASH	1500-3000		30-60	B&B	
C	13	PINUS STROBUS	WHITE PINE	1500-3000		30-60	B&B	
D	8	POPULUS DELTOIDES	EASTERN COTTONWOOD	1500-3000		30-60	B&B	
E	10	QUERCUS ALBA	WHITE OAK	1500-3000		30-60	B&B	
F	15	QUERCUS BICOLOR	SWAMP WHITE OAK	1500-3000		30-60	B&B	
G	15	SALIX NIGRA	BLACK WILLOW	1500-3000		30-60	B&B	

TOTAL DECIDUOUS TREES: 106

CONIFEROUS TREES

H	13	PICEA GLAUCA	WHITE SPRUCE	1500-2500		30-50	B&B	
I	8	PINUS STROBUS	EASTERN WHITE PINE	2000-3000		30-60	B&B	
J	10	THUJA OCCIDENTALIS	EASTERN WHITE CEDAR	1500-2500		30-50	B&B	

TOTAL CONIFEROUS TREES: 31

KEY	TOTAL	BOTANICAL NAME	COMMON NAME	HEIGHT (mm)	SPREAD
SHRUBS					
a	80	AMELANCHIER ARBOREA	DOWNY JUNE BERRY	600	
b	75	AMELANCHIER LAEVIS WIEGAND	SMOOTH JUNE BERRY	600	
c	55	CEPHALANTHUS OCCIDENTALIS	BUTTON BUSH	600	
d	105	CORNUS STOLONIFERA	RED-OSIER DOGWOOD	600	
e	80	DIERVILLA LONICERA	BUSH HONEYSUCKLE	600	
f	75	ILEX VERTICILLATA	WINTER BERRY	600	
g	45	RHUS TYPHINA	STAGHORN SUMAC	600	
h	39	RIBES AMERICANUM	WILD BLACK CURRANT	600	
i	100	RUBUS ALLEGHENIENSIS	COMMON BLACKBERRY	600	
j	100	SALIX ERIOCEPHALA	HEART-LEAVED WILLOW	600	
k	100	SALIX LUCIDA	SHINING WILLOW	600	
l	100	SAMBUCUS RACEMOSA SSP 'PUBENS'	RED-BERRIED ELDER	600	
m	100	SAMBUCUS CANADENSIS	COMMON ELDER	600	
n	50	SHEPHERDIA CANADENSIS	SOAP BERRY	600	
o	50	VIBURNUM ACERIFOLIUM	MAPLE-LEAVED VIBURNUM	600	
p	75	VIBURNUM LENTAGO	NANNY BERRY	600	

TOTAL SHRUBS: 1229

TOTAL	BOTANICAL NAME	COMMON NAME	HEIGHT (mm)	SPREAD
GROUND COVER				
q	30	EUONYMUS OBOVATA	RUNNING STRAWBERRY-BUSH	600

TOTAL GROUND COVER: 30

AQUATIC AND SHORELINE PLANT LIST: POND NO. 1

KEY	TOTAL	BOTANICAL NAME	COMMON NAME	HEIGHT	ZONE	COND.
ZONE ONE: DEEP WATER ZONE						
aa	60	ELODEA CANADENSIS	WATERWEED	100 min	SUB	POTTED
bb	75	NYMPHAEA ODORATA	FRAGRANT WATER-LILY	100 min	FL	POTTED
cc	54	POTAMOGETON PECTINATUS	SAGO PONDWEED	100 min	SUB	POTTED
dd	47	RUDBECKIA HIRTA	BLACK-EYED SUSAN	100 min		POTTED
ee	44	SAGITTARIA LATIFOLIA	COMMON ARROWHEAD	100 min		POTTED
ff	38	TYPHA LATIFOLIA	COMMON CATTAIL	100 min		POTTED

TOTAL: 318

ZONE TWO: AQUATIC ZONE

gg	72	ALISMA PLANTAGO-AQUATICA	WATER-PLANTAIN	100 min	EM	PLUG
hh	38	CAREX BEBBII	BEBB'S SEDGE	100 min	EM	PLUG
ii	44	CAREX HYSTERICINA	PORCUPINE SEDGE	150 min	EM	PLUG
jj	42	CAREX VULPINOIDEA	FOX SEDGE	150 min	EM	PLUG
kk	42	JUNCUS DUDLEYI	DUDLEY'S RUSH	150 min		PLUG
ll	59	JUNCUS EFFUSUS SSP. SOLUTUS	COMMON RUSH	150 min		PLUG
mm	55	SCIRPUS ATROVIRENS	BLACK BULRUSH	150 min		PLUG
nn	39	SCIRPUS VALIDUS	SOFTSTEM BULRUSH	150 min		PLUG

TOTAL: 392

NOTE:

1. BARE ROOT PLANTING STOCK WILL BE SUBSTITUTED WITH POTTED MATERIAL IF THE PLANTING TAKES PLACE OUTSIDE THE BARE ROOT SEASON.
2. CONTRACTOR SHALL CONFIRM THAT ALL QUANTITIES SHOWN ON THE PLANT LIST CONFORM WITH THE PLANS.
3. THE QUANTITIES SHOWN ON THE PLAN SUPERSEDE THE TOTALS OF THE LIST. REPORT ANY DISCREPANCIES TO THE LANDSCAPE ARCHITECT.

GENERAL NOTES:

1. THIS PLAN TO BE USED FOR STORMWATER MANAGEMENT POND NO. 1 PLANTING WORKS ONLY.
2. BASE INFORMATION OBTAINED FROM FRONTENAC FOREST ESTATES INC.
3. LANDSCAPE CONTRACTOR SHALL PROVIDE LANDSCAPE ARCHITECT 48 HOURS NOTICE PRIOR TO COMMENCEMENT.
4. REFER TO DWGS SWM-2, SWM-4 FOR SEEDING PLAN, SWM-5 NOTES AND PLANT LIST, AND D1 FOR DETAILS.

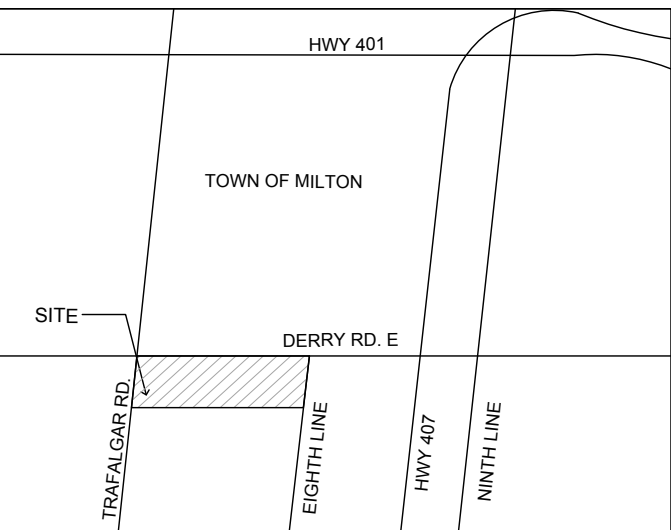

KEY MAP

LEGEND:

- DEVELOPABLE LIMIT LINE
- - - - - NORMAL WATER LIMIT - 189.00
- - - - - SPILLWAY ELEV. - 192.10
- - - - - EXTENDED DETENTION WATER LIMIT - 190.00
- - - - - 1.8m HIGH CHAIN LINK FENCE
- 118.40 PROPOSED POND CONTOUR ELEVATION
- 1 NUMBER OF PLANT
- E PLANT KEY
- + DECIDUOUS TREES
- \* CONIFEROUS TREES
- PROPOSED EMERGENT AQUATICS
- PROPOSED FLOATING AQUATICS
- PROPOSED AQUATICS
- PROPOSED SUBMERGENT AQUATICS
- PROPOSED SHORELINE FRINGE CONTINUOUS MULCH SHRUB BED
- PROPOSED FLOOD FRINGE CONTINUOUS MULCH SHRUB BED
- PROPOSED UPLAND CONTINUOUS MULCH SHRUB BED
- SPILLWAYS
- BANK STABILIZATION SEED MIX 'A'
- UPLAND MEADOW SEED MIX 'B'

RO	ISSUED FOR FIRST SUBMISSION	20250303	
no.	revision	date	by

THESE DRAWINGS ARE THE PROPERTY OF CGLA CONSULTANTS INC. AND SHALL NOT BE ALTERED, MODIFIED, REVISED, OR CHANGED WITHOUT THE WRITTEN CONSENT OF CGLA CONSULTANTS INC. SEA IS NOT VALID WITHOUT SIGNATURE OF THE LANDSCAPE ARCHITECT. DRAWINGS CANNOT BE USED FOR TENDER/CONSTRUCTION UNTIL SIGNED BY LANDSCAPE ARCHITECT.

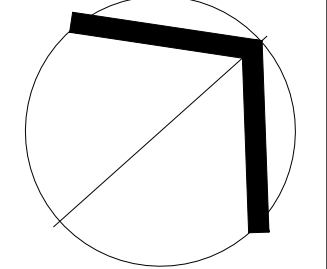

Client:  
**FRONTENAC FOREST ESTATES INC.**

Project Title:  
**FRONTENAC FOREST TOWN OF MILTON**

Drawing Title:  
**SWM POND RESTORATION LANDSCAPE PLAN**

Reviewed: DB Drawn: CJ

Scale: 1:500 Date: 20250303

Project Number: 2813

Drawing Number  
**SWMP\_1**



user: Cathy\Jin file: P:\PROJECTS\2813 - Frontenac Forest\1 - Frontenac Forest\CAD\Frontenac\_2025-03-03\CGLA - SWM Plans.dwg plot: Mar 27, 2025 - 10:28am



SEEDING NOTES:

SEED SHALL BE A PNEUMATICALLY APPLIED MIXTURE OF COMPOSTED ORGANICS PROVIDED BY LANDSOURCE ORGANICS LTD. (TERRASEEDING) OR APPROVED EQUAL APPLIED TO DEPTH OF 50mm.  
DO NOT FERTILIZE. SEEDING. ALL SEEDING SHALL BE COMPLETED MAY 15 - JUNE 30 OR SEPTEMBER 1 - SEPTEMBER 21.  
COVER CROP: ANNUAL OATS (Avena sativa) TO BE APPLIED IN ANY SEASON IF NECESSARY.

- 1ST GROWING SEASON
- DO NOT CUT
  - WATER BI-WEEKLY UNTIL ONSET OF FROST WITH SUFFICIENT AMOUNTS TO ENSURE GERMINATION
  - WEED REMOVAL BY HAND AS NECESSARY
- 2ND GROWING SEASON
- ONCE SWARD HAS REACHED 100mm CUT BY HAND AT 50mm HEIGHT. ENSURE CUTTINGS ARE EJECTED AWAY FROM OPEN WATER
  - CUT TO A HEIGHT OF 300mm IN MID-SUMMER, ONCE BIENNIAL WEEDS SUCH AS SWEET CLOVER ARE IN FULL BLOOM
  - CUT AGAIN IN OCTOBER TO A HEIGHT OF 150-300mm
- 3RD AND ALTERNATING GROWING SEASONS
- ONCE SWARD HAS REACHED A HEIGHT OF 100mm, CUT BY HAND TO 50mm HEIGHT

OPTIONAL TEMPORARY SEEDING (POND)

NOTE: ALL PROPOSED TOPSOIL AND SEEDED AREAS TO BE TEMPORARILY STABILIZED WITH ANNUAL OATS (AVENA SATIVA) TO BE APPLIED BY HAND, IN ANY SEASON.  
- SEEDING RATE: 30KG/HA  
- DO NOT FERTILIZE  
- SHOULD FINAL PLANTING NOT PROCEED FOLLOWING ONE GROWING SEASON AREA TO BE RE-STABILIZED WITH ANNUAL OATS.

BANK STABILIZATION SEED MIX 'A'

TO NORMAL WATER LEVEL  
ELEVATION 189.00  
TOTAL AREA: 9632m2

% COMPOSITION	BOTANICAL NAME	COMMON NAME
GRASSES		
20%	Andropogon gerardii	BIG BLUESTEM
15%	Calamagrostis canadensis	CANADA BLUE JOINT
10%	Elymus canadensis	CANADA WILD RYE
15%	Glyceria striata	FOWL MANNA GRASS
15%	Panicum virgatum	SWITCH GRASS
10%	Sorghastrum nutans	INDIAN GRASS
FORBS		
15%	Asclepias incarnata	SWAMP MILKWEED
100%	Aster ericoides	HEATH ASTER
	Eupatorium maculatum	JOE-PYE WEED
	Liatris spicata	DENSE BLAZING STAR
	Monarda fistulosa	WILD BERGAMOT
	Oenothera biennis	EVENING PRIMROSE
	Rudbeckia hirta	BLACK-EYED SUSAN

UPLAND MEADOW SEED MIX 'B'

ABOVE ELEVATION 192.10  
TO POND BLOCK LIMIT OF SUBDIVISION  
TOTAL AREA INCLUDING MOW ZONE: 3604m2

% COMPOSITION	BOTANICAL NAME	COMMON NAME
GRASSES		
30%	Andropogon scoparius	LITTLE BLUESTEM
20%	Elymus canadensis	CANADA WILD RYE
5%	Elymus hystrix	BOTTLEBRUSH GRASS
10%	Bouteloua curtipendula	SIDE OATS GRAMA
15%	Sorghastrum nutans	INDIAN GRASS
FORBS		
20%	Anemone virginiana	TALL ANEMONE
100%	Aster ericoides	HEATH ASTER
	Aster lateriflorus	CALICO ASTER
	Aster novae-angliae	NEW ENGLAND ASTER
	Lespedeza capitata	ROUND HEADED BUSH CLOVER
	Rudbeckia hirta	BLACK-EYED SUSAN
	Siphilium laciniatum	COMPASS PLANT
	Solidago flexicaulis	ZIG ZAG GOLDENROD
	Solidago juncea	EARLY GOLDENROD
	Solidago patula	ROUGH-LEAVED GOLDENROD
	Solidago rugosa	ROUGH GOLDENROD
	Verbena stricta	HOARY VERVAIN
	Vernonia altissima	IRONWEED

GENERAL NOTES:

- THIS PLAN TO BE USED FOR STORMWATER MANAGEMENT POND NO.1 PLANTING WORKS ONLY.
- BASE INFORMATION OBTAINED FROM FRONTENAC FOREST ESTATES INC.
- LANDSCAPE CONTRACTOR SHALL PROVIDE LANDSCAPE ARCHITECT 48 HOURS NOTICE PRIOR TO COMMENCEMENT.
- REFER TO DWGS SWM-2, SWM-4 FOR SEEDING PLAN, SWM-5 NOTES AND PLANT LIST, AND D1 FOR DETAILS.

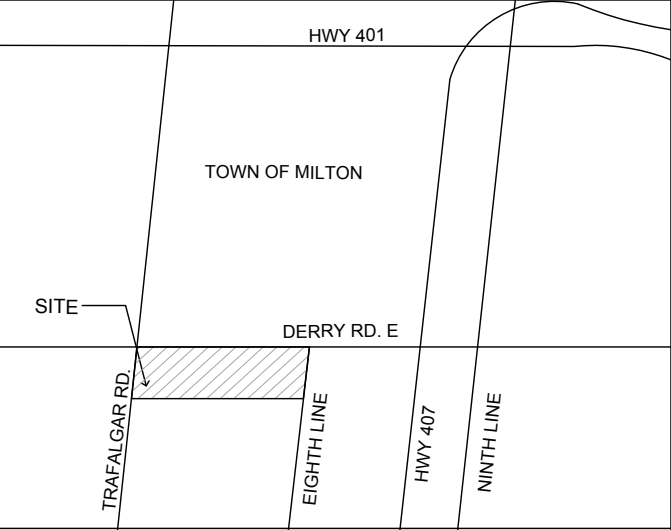

KEY MAP

LEGEND:

- DEVELOPABLE LIMIT LINE
- NORMAL WATER LIMIT - 189.00
- SPILLWAY ELEV. - 192.10
- EXTENDED DETENTION WATER LIMIT - 190.00
- 1.8m HIGH CHAIN LINK FENCE
- PROPOSED POND CONTOUR ELEVATION
- SPILLWAYS
- BANK STABILIZATION SEED MIX 'A'
- UPLAND MEADOW SEED MIX 'B'

RO	ISSUED FOR FIRST SUBMISSION	20250303
no.	revision	date
		by

THESE DRAWINGS ARE THE PROPERTY OF CGLA CONSULTANTS INC. AND SHALL NOT BE ALTERED, MODIFIED, REVISED, OR CHANGED WITHOUT THE WRITTEN CONSENT OF CGLA CONSULTANTS INC. SEAL IS NOT VALID WITHOUT SIGNATURE OF THE LANDSCAPE ARCHITECT. DRAWINGS CANNOT BE USED FOR TENDER/CONSTRUCTION UNTIL SIGNED BY LANDSCAPE ARCHITECT.

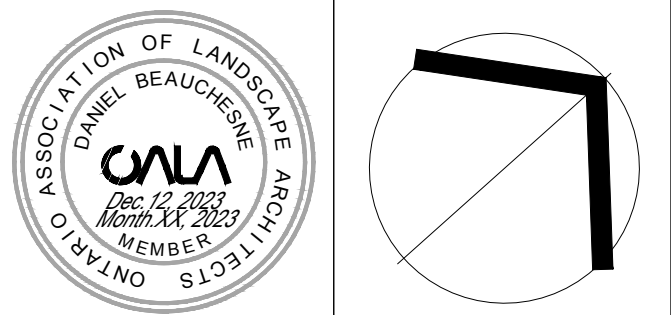

**CGLA**  
30 CENTURIAN DRIVE, UNIT 105  
MARKHAM, ONTARIO L3R 8B9  
Telephone: 905-475-6988 Email: info@cgl.ca www.cgl.ca

Client:  
**FRONTENAC FOREST ESTATES INC.**

Project Title:  
**FRONTENAC FOREST TOWN OF MILTON**

Drawing Title:  
**SWM POND RESTORATION SEEDING PLAN**

Reviewed: DB Drawn: CJ

Scale: 1:500 Date: 20250303

Project Number: 2813

Drawing Number  
**SWMP\_2**



user: Cathy\Jin file: P:\PROJECTS\2813 - Frontenac Forest\1 - Design Phase\CAD\Frontenac\_2025-03-03\CGLA - SWM Plans.dwg plot: Mar 27, 2025 - 10:28am

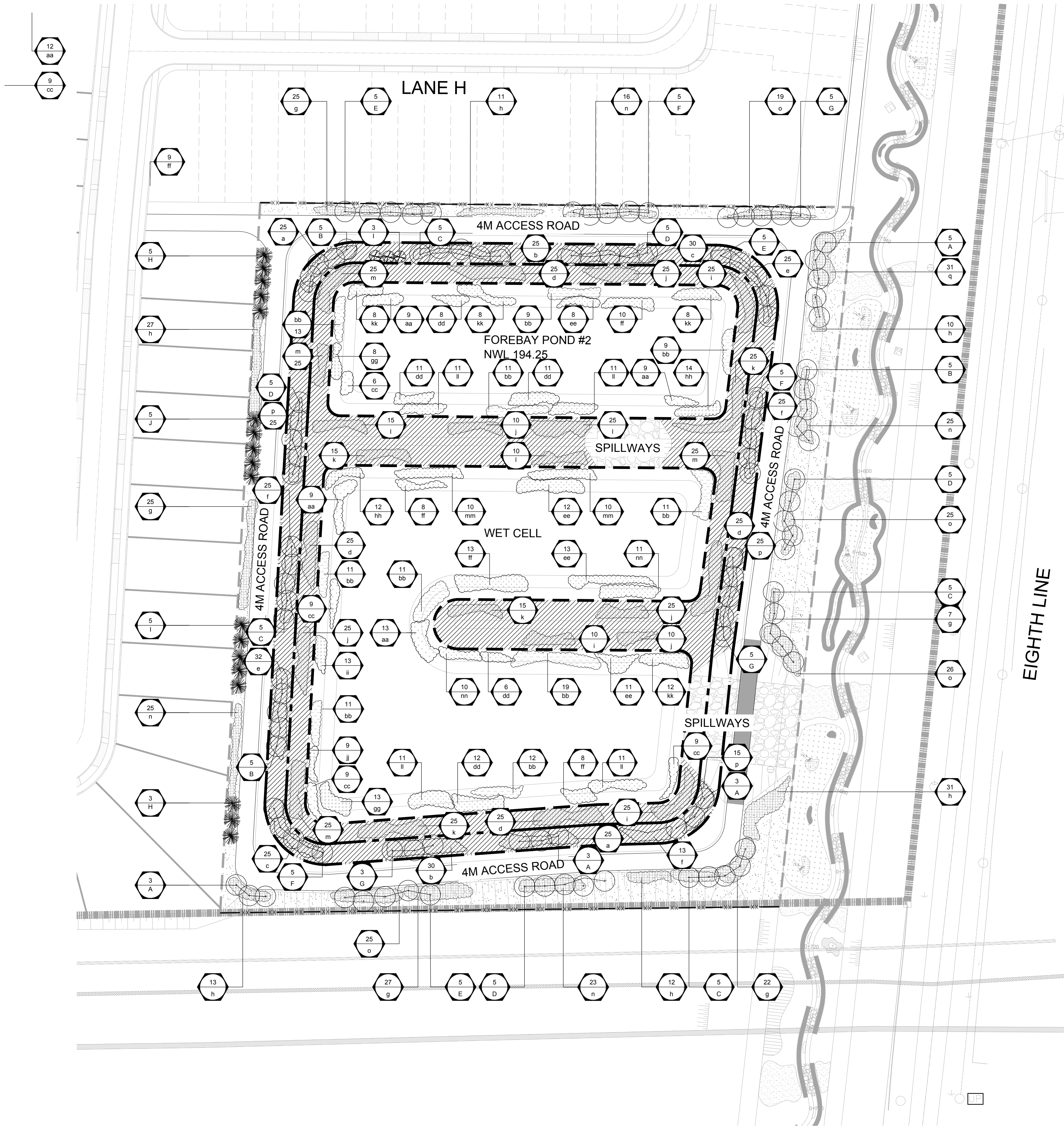

MASTER PLANT LIST								
KEY	TOTAL	BOTANICAL NAME	COMMON NAME	HEIGHT (mm)	SPREAD (mm)	CALIPER (mm)	COND.	REMARKS
DECIDUOUS TREES								
A	14	ACER SACCHARINUM	SILVER MAPLE	1500-3000		30-60	B&B	
B	15	FRAXINUS PENNSYLVANICA	GREEN ASH	1500-3000		30-60	B&B	
C	20	PINUS STROBUS	WHITE PINE	1500-3000		30-60	B&B	
D	20	POPULUS DELTOIDES	EASTERN COTTONWOOD	1500-3000		30-60	B&B	
E	15	QUERCUS ALBA	WHITE OAK	1500-3000		30-60	B&B	
F	15	QUERCUS BICOLOR	SWAMP WHITE OAK	1500-3000		30-60	B&B	
G	13	SALIX NIGRA	BLACK WILLOW	1500-3000		30-60	B&B	

TOTAL DECIDUOUS TREES: 112

CONIFEROUS TREES							
H	8	PICEA GLAUCA	WHITE SPRUCE	1500-2500	30-50	B&B	
I	8	PINUS STROBUS	EASTERN WHITE PINE	2000-3000	30-60	B&B	
J	5	THUJA OCCIDENTALIS	EASTERN WHITE CEDAR	1500-2500	30-50	B&B	

TOTAL CONIFEROUS TREES: 21

KEY	TOTAL	BOTANICAL NAME	COMMON NAME	HEIGHT (mm)	SPREAD
SHRUBS					
a	50	AMELANCHIER ARBOREA	DOWNY JUNE BERRY	600	
b	55	AMELANCHIER LAEVIS WIEGAND	SMOOTH JUNE BERRY	600	
c	55	CEPHALANTHUS OCCIDENTALIS	BUTTON BUSH	600	
d	100	CORNUS STOLONIFERA	RED-OSIER DOGWOOD	600	
e	57	DIERVILLA LONICERA	BUSH HONEYSUCKLE	600	
f	63	ILEX VERTICILLATA	WINTER BERRY	600	
g	106	RHUS TYPHINA	STAGHORN SUMAC	600	
h	104	RIBES AMERICANUM	WILD BLACK CURRANT	600	
i	85	RUBUS ALLEGHENIENSIS	COMMON BLACKBERRY	600	
j	75	SALIX ERIOCEPHALA	HEART-LEAVED WILLOW	600	
k	80	SALIX LUCIDA	SHINING WILLOW	600	
l	75	SAMBUCUS RACEMOSA SSP 'PUBENS'	RED-BERRIED ELDER	600	
m	100	SAMBUCUS CANADENSIS	COMMON ELDER	600	
n	89	SHEPHERDIA CANADENSIS	SOAP BERRY	600	
o	95	VIBURNUM ACERIFOLIUM	MAPLE-LEAVED VIBURNUM	600	
p	65	VIBURNUM LENTAGO	NANNY BERRY	600	

TOTAL SHRUBS: 1254

TOTAL	BOTANICAL NAME	COMMON NAME	HEIGHT (mm)	SPREAD
GROUND COVER				
q	31	EUONYMUS OBOVATA	RUNNING STRAWBERRY-BUSH	600

TOTAL GROUND COVER: 31

AQUATIC AND SHORELINE PLANT LIST: POND NO. 2					
KEY	TOTAL	BOTANICAL NAME	COMMON NAME	HEIGHT	ZONE   COND.
ZONE ONE: DEEP WATER ZONE					
aa	40	ELODEA CANADENSIS	WATERWEED	100 min	SUB   POTTED
bb	117	NYMPHAEA ODORATA	FRAGRANT WATER-LILY	100 min	FL   POTTED
cc	33	POTAMOGETON PECTINATUS	SAGO PONDWEED	100 min	SUB   POTTED
dd	49	RUDBECKIA HIRT	BLACK-EYED SUSAN	100 min	POTTED
ee	44	SAGITTARIA LATIFOLIA	COMMON ARROWHEAD	100 min	POTTED
ff	39	TYPHA LATIFOLIA	COMMON CATTAIL	100 min	POTTED
TOTAL: 322					
ZONE TWO: AQUATIC ZONE					
gg	21	ALISMA PLANTAGO-AQUATICA	WATER-PLANTAIN	100 min	EM   PLUG
hh	26	CAREX BEBBII	BEBB'S SEDGE	100 min	EM   PLUG
ii	13	CAREX HYSTERICINA	PORCUPINE SEDGE	150 min	EM   PLUG
jj	9	CAREX VULPINOIDEA	FOX SEDGE	150 min	EM   PLUG
kk	36	JUNCUS DUDLEYI	DUDLEY'S RUSH	150 min	EM   PLUG
ll	44	JUNCUS EFFUSUS SSP. SOLUTUS	COMMON RUSH	150 min	PLUG
mm	20	SCIRPUS ATROVIRENS	BLACK BULRUSH	150 min	PLUG
nn	21	SCIRPUS VALIDUS	SOFTSTEM BULRUSH	150 min	PLUG
TOTAL: 190					

NOTE:  
1. BARE ROOT PLANTING STOCK WILL BE SUBSTITUTED WITH POTTED MATERIAL IF THE PLANTING TAKES PLACE OUTSIDE THE BARE ROOT SEASON.  
2. CONTRACTOR SHALL CONFIRM THAT ALL QUANTITIES SHOWN ON THE PLANT LIST CONFORM WITH THE PLANS.  
THE QUANTITIES SHOWN ON THE PLAN SUPERSEDE THE TOTALS OF THE LIST. REPORT ANY DISCREPANCIES TO THE LANDSCAPE ARCHITECT.

GENERAL NOTES:

- THIS PLAN TO BE USED FOR STORMWATER MANAGEMENT POND NO.2 PLANTING WORKS ONLY.
- BASE INFORMATION OBTAINED FROM FRONTENAC FOREST ESTATES INC.
- LANDSCAPE CONTRACTOR SHALL PROVIDE LANDSCAPE ARCHITECT 48 HOURS NOTICE PRIOR TO COMMENCEMENT.
- REFER TO DWGS SWM-2, SWM-4 FOR SEEDING PLAN, SWM-5 NOTES AND PLANT LIST, AND D1 FOR DETAILS.

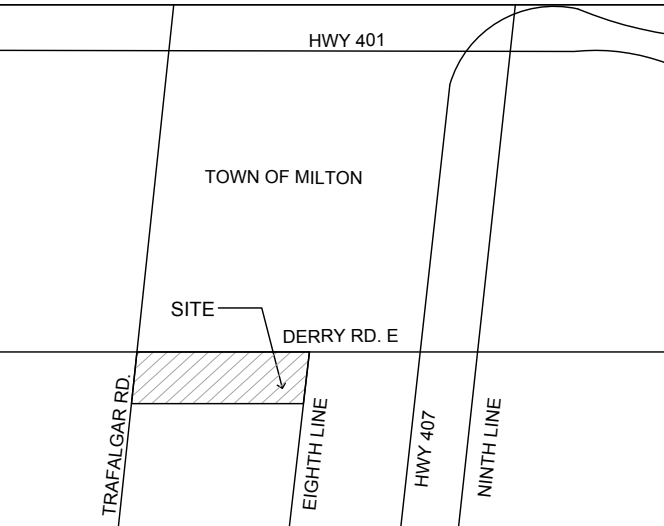

KEY MAP

- LEGEND:
- DEVELOPABLE LIMIT LINE
  - NORMAL WATER LIMIT - 194.25
  - SPILLWAY ELEV. - 196.05
  - EXTENDED DETENTION WATER LIMIT - 195.25
  - PROPOSED POND CONTOUR ELEVATION
  - 1.8m HIGH CHAIN LINK FENCE

- 1  
E  
PLANT KEY

- DECIDUOUS TREES  
CONIFEROUS TREES

- PROPOSED EMERGENT AQUATICS

- PROPOSED FLOATING AQUATICS

- PROPOSED AQUATICS

- PROPOSED SUBMERGENT AQUATICS

- PROPOSED SHORELINE FRINGE CONTINUOUS MULCH SHRUB BED

- PROPOSED FLOOD FRINGE CONTINUOUS MULCH SHRUB BED

- PROPOSED UPLAND CONTINUOUS MULCH SHRUB BED

- SPILLWAYS

- BANK STABILIZATION SEED MIX 'A'

- UPLAND MEADOW SEED MIX 'B'

R0	ISSUED FOR FIRST SUBMISSION	20250303	
no.	revision	date	by

THESE DRAWINGS ARE THE PROPERTY OF CGLA CONSULTANTS INC. AND SHALL NOT BE ALTERED, MODIFIED, REVISED, OR CHANGED WITHOUT THE WRITTEN CONSENT OF CGLA CONSULTANTS INC. SEA IS NOT VALID WITHOUT SIGNATURE OF THE LANDSCAPE ARCHITECT. DRAWINGS CANNOT BE USED FOR TENDER/CONSTRUCTION UNLESS SIGNED BY LANDSCAPE ARCHITECT.

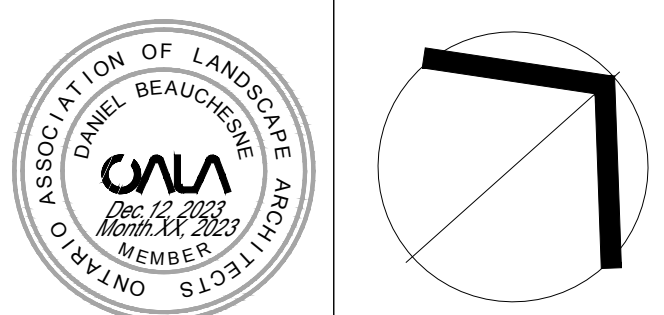

Client:  
FRONTENAC FOREST ESTATES INC.

Project Title:  
FRONTENAC FOREST TOWN OF MILTON

Drawing Title:  
SWM POND RESTORATION LANDSCAPE PLAN

Reviewed: DB Drawn: CJ

Scale: 1:500 Date: 20250303

Project Number: 2813

Drawing Number  
SWMP\_3







user: Cathy\jin file: P:\PROJECTS\2813 - Frontenac Forest\1 - Design Phase\CAD\Frontenac\_2025-03-03\CGLA -SWM Plans.dwg plot: Mar 27, 2025 - 10:28am

POND MAINTENANCE PROGRAM (2 YEAR)

1. ALL PLANTINGS SHALL BE WATERED BI-WEEKLY DURING JUNE 15 - SEPTEMBER 15 PERIOD AND WEEKLY DURING PERIODS OF DROUGHT (ANY PERIOD OVER 3 WEEKS WITHOUT RAIN).
2. EARLY SPRING AND FALL VEGETATION MANAGEMENT SHALL INCLUDE THE FOLLOWING TASKS:

- WEED CUTTING AND REMOVAL BY HAND TRIMMER AND DISPOSAL OFF SITE

- PRUNING ALL DEAD, DISEASED OR DAMAGED MATERIAL FROM ALL TREES AND SHRUBS

- DISPOSAL OF ALL MAN-MADE DEBRIS OFF SITE

- ADDITION OF 50mm DEEP SHREDDED BARK MULCH TO ALL BEDS AND TREE PITS
3. INVASIVE ALIEN SPECIES FOUND GROWING WITHIN POND RESTORATION ZONE SHALL BE REMOVED FULLY IN SPRING AND FALL EACH YEAR BY HAND AND DISPOSED OF OFF SITE. INVASIVE ALIEN SPECIES TO BE REMOVED INCLUDE THE FOLLOWING:

Rhamnus cathartica - COMMON BUCKTHORN

Acer platanoides - NORWAY MAPLE

Alliaria petiolata - GARLIC MUSTARD

Cynanchum rossicum - DOG STRANGLING VINE

Acer negundo - MANITOBA MAPLE
4. MONITOR PERFORMANCE OF ALL PLANTING INCLUDING SEEDING AND EROSION CONTROL MEASURES.

POND REHABILITATION SEED MIXTURE

1. SEED AT A RATE OF 20kg/ha. INOCULATE WITH RHIZOBIA. SEED ON A WELL WORKED SEED BED - DO NOT FERTILIZE. SEEDING SHALL BE COMPLETED DURING EARLY SPRING OR FALL (MAY 15-30 OR SEPTEMBER 1-21).
2. SEEDING SHALL BE COMPLETED WITH THE FOLLOWING METHOD:

A FRESH OR STRATIFIED SEED WILL BE APPLIED WITH CLEAN, WEED FREE COMPOST USING PNEUMATIC BLOWN IN COMPOST METHOD ('TERRASEED' OR APPROVED EQUAL).
3. TERRASEEDING SHALL BE COMPLETED CONCURRENTLY OR IMMEDIATELY AFTER PLANTING AT A DEPTH OF 50mm MINIMUM, INCLUDING ACCESS ROAD AND TURFSTONE SURFACES.
4. ALL AREAS DISTURBED BY POND SILT CLEAN OUT SHALL BE RE-SEEDED USING APPROVED NATIVE SEED MIXTURE.

RESTORATION PLANTING NOTES:

1. ALL PLANT MATERIAL SHALL BE MAINTAINED BY THE CONTRACTOR IMMEDIATELY FOLLOWING PLANTING UNTIL THE DATE OF ACCEPTANCE.
2. MAINTENANCE SHALL INCLUDE ALL MEASURES NECESSARY TO ESTABLISH AND MAINTAIN ALL PLANTS IN AN ACCEPTABLE, VIGOROUS AND HEALTHY CONDITION INCLUDING CULTIVATING AND WEEDING, WATERING WHEN REQUIRED, PRUNING AND MAINTENANCE OS ALL ACCESSORIES.
3. ALL PLANT MATERIALS SHALL BE GUARANTEED FOR A PERIOD OF 2 (TWO) YEAR UNLESS OTHERWISE NOTED.
4. AT TIME OF INSPECTION FOR ACCEPTANCE, ALL PLANTING BEDS AND TREE PITS SHALL BE CULTIVATED, FREE OF WEEDS, BROKEN BRANCHES AND DEBRIS.
5. THE CONTRACTOR SHALL BE RESPONSIBLE FOR THE PROTECTION OF ALL TREES AND SHRUBS FROM RODENT AND OTHER DAMAGE FOR THE DURATION OF THE GUARANTEE PERIOD. PROTECTIVE COLLARS SHALL BE INSTALLED PRIOR TO THE APPLICATION OF SHREDDED BARK MULCH. COLLARS SHALL BE FLEXIBLE PLASTIC COMPOSITION, A MINIMUM OF 400mm HIGH AND 100mm IN DIAMETER.
6. THE CONTRACTOR SHALL REMOVE ALL T-BAR TREE STAKES PRIOR TO ACCEPTANCE BY THE TOWN OF NEW TECUMSETH.
7. ALL AREAS DISTURBED BY CONSTRUCTION ACTIVITY SHALL BE TERRASEEDED WITH SPECIFIED REHABILITATION SEED MIXTURE.
8. AQUATIC AND SHORELINE PLANTING TO BE COMPLETED CONCURRENT WITH POND BANK PLANTING. SUBMERGENT AQUATIC PLANTS SHALL BE MATURE POTTED PLANTS PLANTED AT 0.3 TO 0.75 METRE DEPTH. EMERGENT AQUATICS (PLUGS) SHALL PLANTED FROM AQUATIC FRINGE TO 0.3 METRE DEPTH. CATTAILS (TYPHA LATIFOLIA) AND BULRUSHES (SCIRPUS SP) SHALL BE INSTALLED AS INTERIM FILTERING VEGETATION IN SEDIMENT FOREBAYS (TO BE REMOVED AT POND CLEAN OUT PRIOR TO POND ASSUMPTION). THEY WILL RECOLONIZE POST DREDGING.
9. THE LANDSCAPE RESTORATION CONTRACTOR SHALL CONTACT THE LANDSCAPE ARCHITECT FOR PLANT SPECIES SUBSTITUTION REQUESTS IMMEDIATELY IN ORDER TO REQUEST CONSERVATION HALTON APPROVAL.
10. PRIOR TO TOPSOILING THE POND BLOCK CONSULTING ENGINEER STAFF SHALL REVIEW THE SUITABILITY OF SUBSOIL MATERIAL AND LEVEL OF COMPACTION WITH LANDSCAPE ARCHITECT.
11. CONTRACTOR SHALL REMOVE ALL WIRE BASKETS AND BURLAP FROM PLANT MATERIAL UPON PLANTING.
12. TOPSOIL DEPTH SHALL BE 450-1000mm FOR ALL AREAS ABOVE THE PERMANENT WATER LEVEL AND 300mm DEPTH MINIMUM FOR THE FIRST 1.0 METRE BELOW THE PERMANENT WATER LEVEL ALONG POND AQUATIC FRINGE.
13. SHRUB PLANTING DENSITIES SHALL BE 2m ON CENTRE.
14. CONTRACTOR SHALL MINIMIZE DISTURBANCE TO SEEDED AREAS. DAMAGE TO SOILS AND SEEDED AREA (AS DETERMINED BY THE LANDSCAPE ARCHITECT) SHALL BE RESTORED BY THE CONTRACTOR, TO THE LANDSCAPE ARCHITECTS APPROVAL, AT THE CONTRACTORS EXPENSE.
15. ANGLE OF REPOSE VARIES WITH STEEP SLOPE AND SOIL CONDITIONS. TAMP TOPSOIL MIX AROUND ROOT SYSTEM IN 150mm THICK LAYERS.
16. SCARIFY SURFACE OF SUBSOIL PRIOR TO PLANTING TREES AND SHRUBS.
17. ALL PLANTS SHALL BE NURSERY GROWN NATIVE STOCK OF LOCAL PROVENANCE CONSERVATION HALTON LOCAL SEED ZONE 34 UNLESS OTHERWISE SPECIFIED.
18. RESTORE ALL DISTURBED AREAS TO ORIGINAL CONDITION AND TO THE SATISFACTION OF THE TOWN OF NEW TECUMSETH.

GENERAL NOTES:

1. THIS PLAN TO BE USED FOR STORMWATER MANAGEMENT POND NO.1 AND NO. 2 PLANTING WORKS ONLY.
2. BASE INFORMATION OBTAINED FROM.
3. LANDSCAPE CONTRACTOR SHALL PROVIDE LANDSCAPE ARCHITECT 48 HOURS NOTICE PRIOR TO COMMENCEMENT.
4. REFER TO DWGS SWM-2, SWM-4 FOR SEEDING PLAN, SWM-5 NOTES AND PLANT LIST, AND D1 FOR DETAILS.

RO	ISSUED FOR FIRST SUBMISSION	20250303	
no.	revision	date	by

THESE DRAWINGS ARE THE PROPERTY OF CGLA CONSULTANTS INC. AND SHALL NOT BE ALTERED, MODIFIED, REVISED, OR CHANGED WITHOUT THE WRITTEN CONSENT OF CGLA CONSULTANTS INC. SEAL IS NOT VALID WITHOUT SIGNATURE OF THE LANDSCAPE ARCHITECT. DRAWINGS CANNOT BE USED FOR TENDER/CONSTRUCTION UNTIL SIGNED BY LANDSCAPE ARCHITECT.

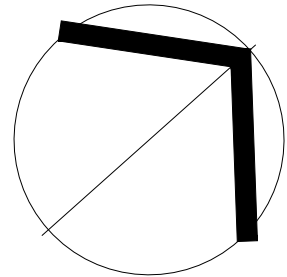

30 CENTURIAN DRIVE, UNIT 105  
MARKHAM, ONTARIO L3R 8B9  
Telephone: 905-475-6988 Email: info@cglia.ca www.cglia.ca

Client:  
**FRONTENAC FOREST ESTATES INC.**

Project Title:  
**FRONTENAC FOREST TOWN OF MILTON**

Drawing Title:  
**SWM POND RESTORATION PLAN LIST AND NOTES**

Reviewed:	DB	Drawn:	CJ
Scale:	NTS	Date:	20250303
Project Number:	2813		
Drawing Number	SWMP_5		



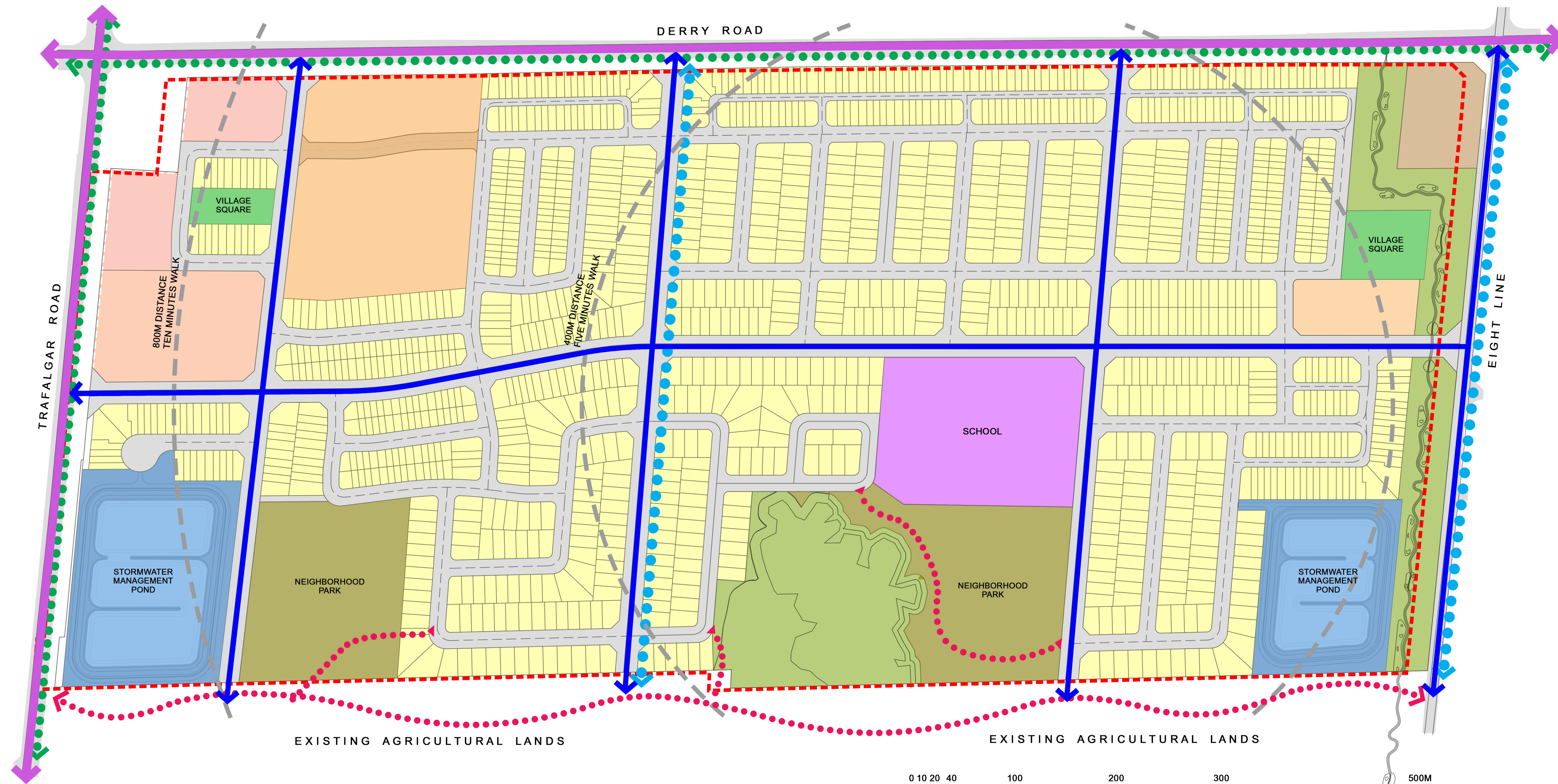

## LOCAL CONTEXT LEGEND

- RESIDENTIAL AREAS
- COMMERCIAL BLOCK
- HIGH-RISE HIGH DENSITY BLOCK
- MID-RISE HIGH DENSITY BLOCK
- MID-RISE MIXED USE BLOCK
- COMMERCIAL MIXED USE BLOCK
- SCHOOL BLOCK
- NEIGHBORHOOD PARK
- VILLAGE SQUARE
- RIGHT OF WAY
- ENVIRONMENTAL LANDS
- STORMWATER MANAGEMENT POND
- MAJOR ARTERIAL ROAD
- COLLECTOR ROAD
- PROPERTY LINE
- WALKSHED
- MULTI-USE PATH
- ON ROAD BIKE LANES
- TRAIL NETWORK



# Frontenac Forest Estates - Town of Milton

CONTEXT CONCEPT PLAN - PARKS, STREETScape & COMMUNITY FACILITIES

APRIL 30, 2025

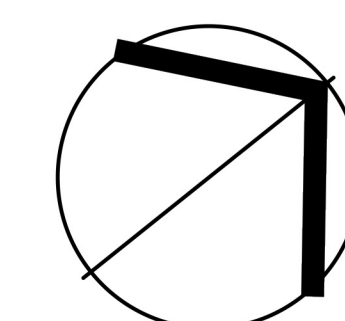

**COSBURN  
GIBERSON** | LANDSCAPE  
ARCHITECTS



# NEIGHBORHOOD PARK 1

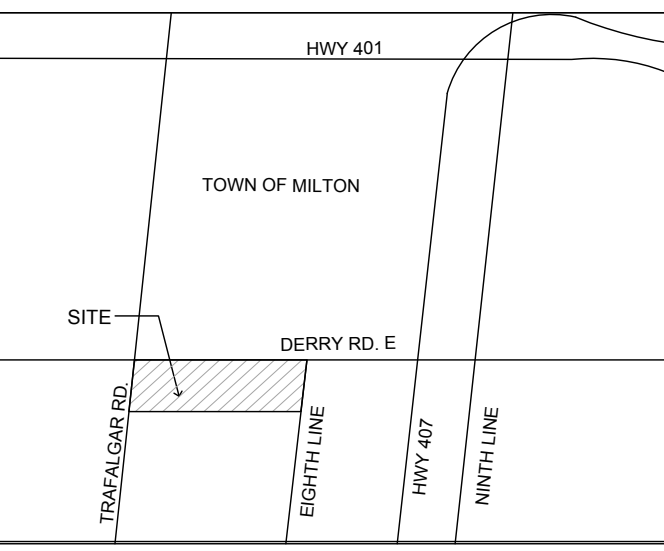
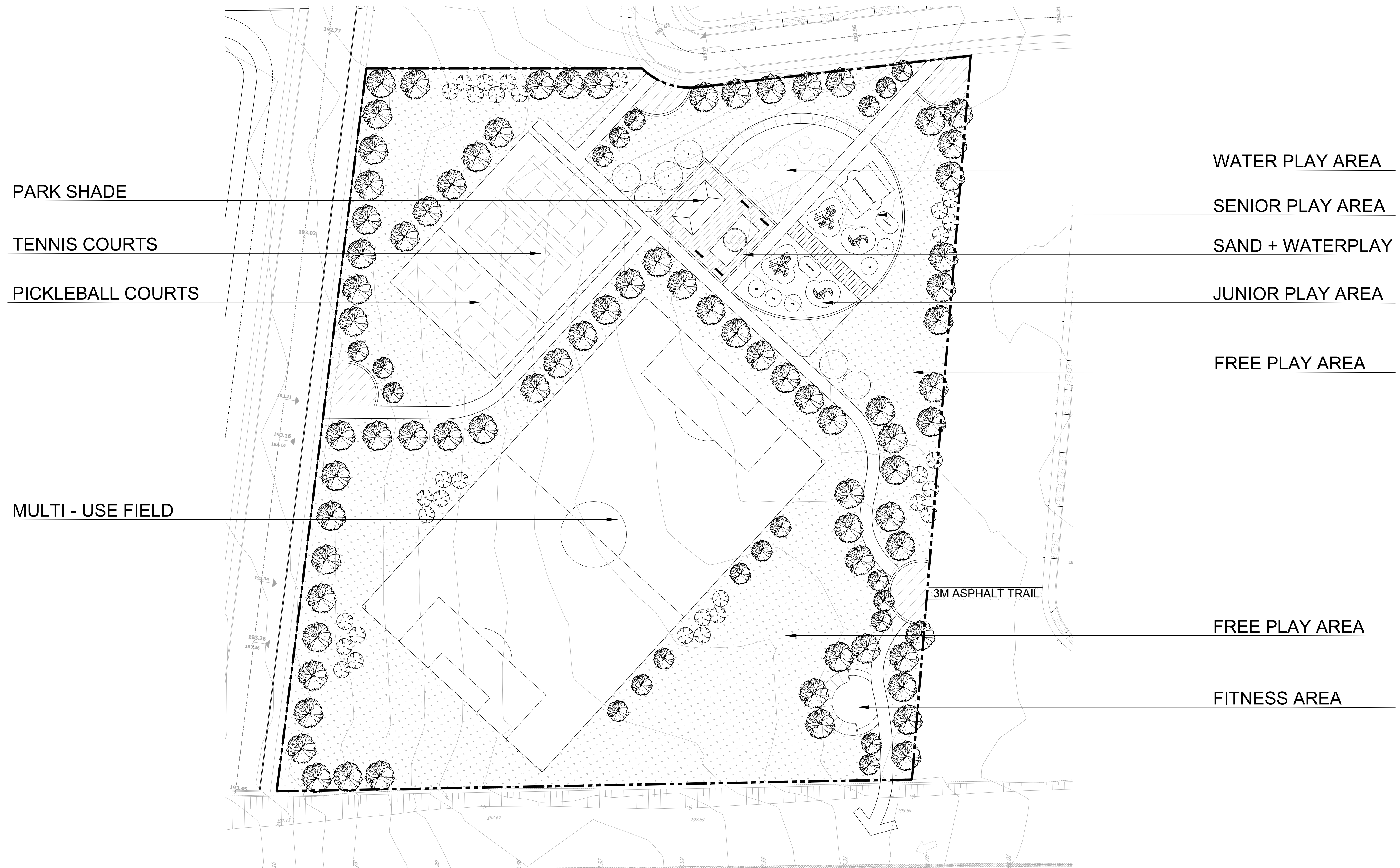

## KEY MAP

LEGEND:

LIMIT OF SUBDIVISION

## SODDING

PROPOSED DECIDUOUS TREES

R0 no.	ISSUED FOR FIRST SUBMISSION revision	20250327 date	CJ by

THESE DRAWINGS ARE THE PROPERTY OF CGLA CONSULTANTS INC. AND SHALL NOT BE ALTERED, MODIFIED, REVISED OR CHANGED WITHOUT THE WRITTEN CONSENT OF CGLA CONSULTANTS INC. SEAL IS NOT VALID WITHOUT SIGNATURE OF THE LANDSCAPE ARCHITECT. DRAWINGS CANNOT BE USED FOR TENDER/CONSTRUCTION UNTIL SIGNED BY LANDSCAPE ARCHITECT.

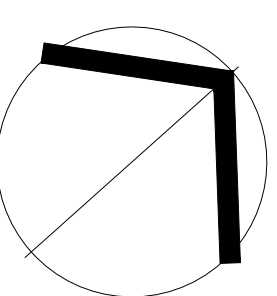

Client:  
FRONTENAC FOREST  
ESTATES INC.

TOWN OF MILTON

Project Title:  
**FRONTENAC FOREST**

Drawing Title:  
NEIGHBORHOOD  
PARK 1  
FACILITY FIT

Reviewed: DB	Drawn: CJ
--------------	-----------

Scale: 1:500	Date: 20250327
--------------	----------------

Project Number: 2813

Drawing Number

Drawing Number **P1**



## NEIGHBORHOOD PARK 2 (OPTION 1)

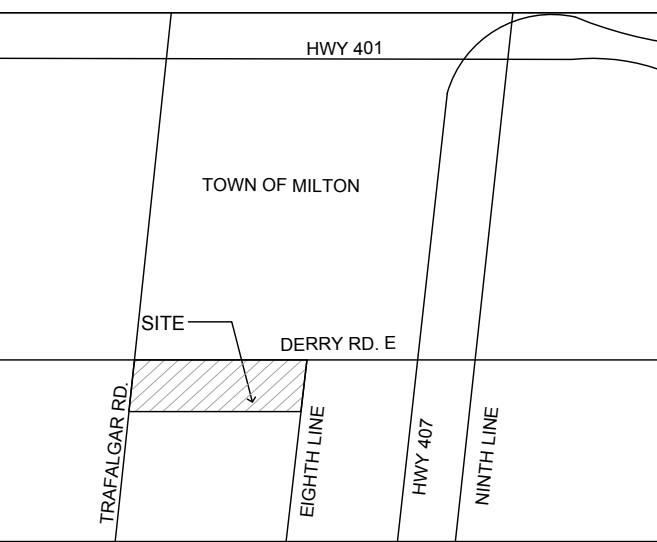

## KEY MAP

LEGEND:

- 

R0	ISSUED FOR FIRST SUBMISSION	20250327	CJ	
no.	revision	date	by	

THESE DRAWINGS ARE THE PROPERTY OF CGLA CONSULTANTS INC. AND SHALL NOT BE ALTERED, MODIFIED, REVISED OR CHANGED WITHOUT THE WRITTEN CONSENT OF CGLA CONSULTANTS INC. SEAL IS NOT VALID WITHOUT SIGNATURE OF THE LANDSCAPE ARCHITECT. DRAWINGS CANNOT BE USED FOR TENDER/CONSTRUCTION UNTIL SIGNED BY LANDSCAPE ARCHITECT.



Client:  
FRONTENAC FOREST  
ESTATES INC.

TOWN OF MILTON

Project Title:  
**FRONTENAC FOREST**

Drawing Title:  
NEIGHBORHOOD  
PARK 2  
FACILITY FIT

Reviewed: DB	Drawn: CJ
Scale: 1:500	Date: 20250327
Project Number: 2813	
Drawing Number	

Drawing Number **P2A**



## NEIGHBORHOOD PARK 2 (OPTION 2)

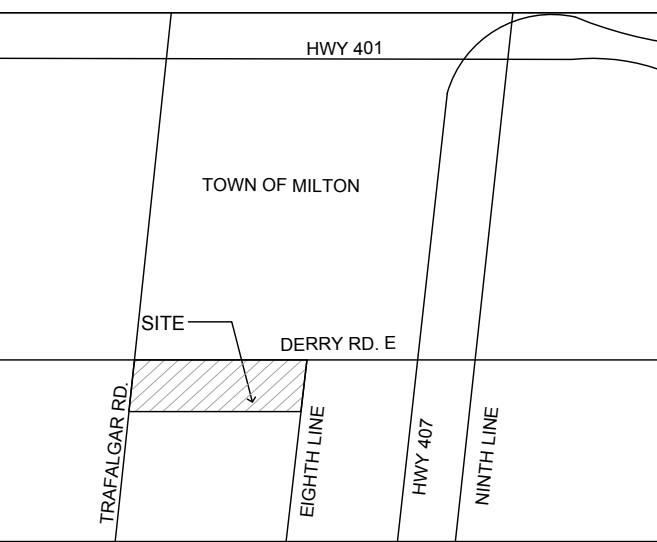
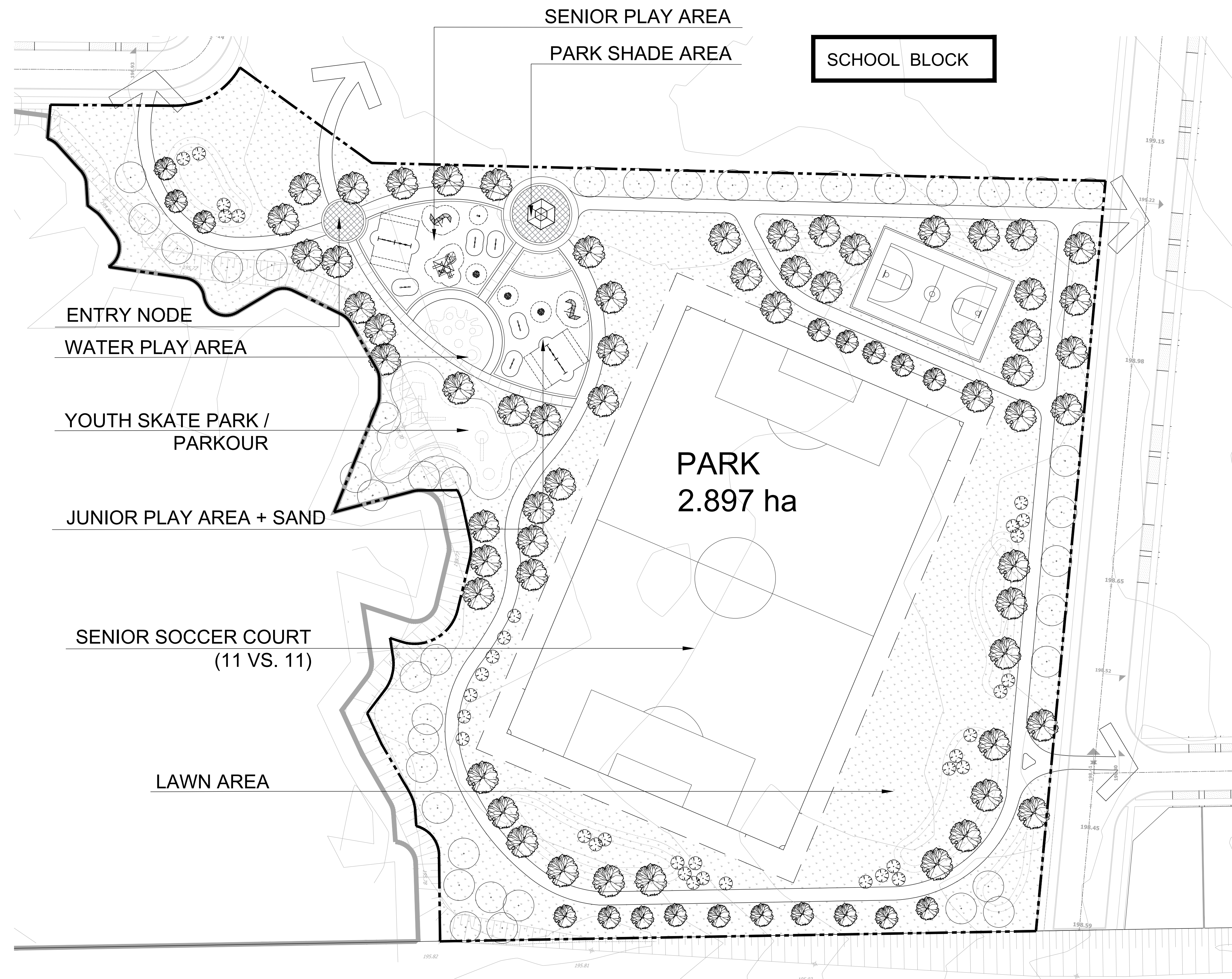

## KEY MAP

LEGEND:

LIMIT OF SUBDIVISION



SODDING



PROPOSED DECIDUOUS TREES

R0	ISSUED FOR FIRST SUBMISSION	20250327	CJ	
no.	revision	date	by	

THESE DRAWINGS ARE THE PROPERTY OF CGLA CONSULTANTS INC. AND SHALL NOT BE ALTERED, MODIFIED, REVISED OR CHANGED WITHOUT THE WRITTEN CONSENT OF CGLA CONSULTANTS INC. SEAL IS NOT VALID WITHOUT SIGNATURE OF THE LANDSCAPE ARCHITECT. DRAWINGS CANNOT BE USED FOR TENDER/CONSTRUCTION UNTIL SIGNED BY LANDSCAPE ARCHITECT.

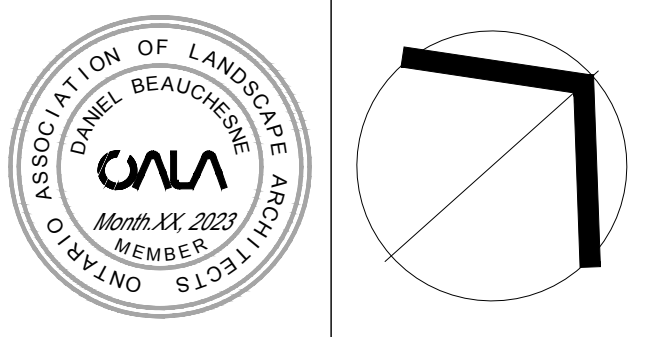

Client:  
FRONTENAC FOREST  
ESTATES INC.

TOWN OF MILTON

Project Title:  
**FRONTENAC FOREST**

Drawing Title:  
NEIGHBORHOOD  
PARK 2  
FACILITY FIT

Reviewed: DB	Drawn: CJ
--------------	-----------

Scale: 1:500	Date: 20250327
--------------	----------------

Project Number: 2813

Drawing Number **D05**

P2B



user: Cathv\jin file: P:\PROJECTS\2813 - Frontenac Forest\1 - Frontenac Forest\1 - Design Phase\CAD\Frontenac\_2025-03-03\CGLA - Park Plans.dwg plot: Mar 31, 2025 - 10:37am

# VILLAGE SQUARE 1

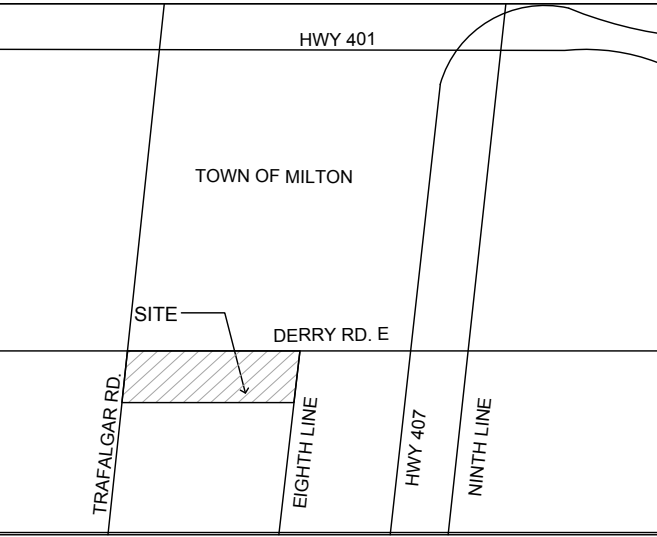
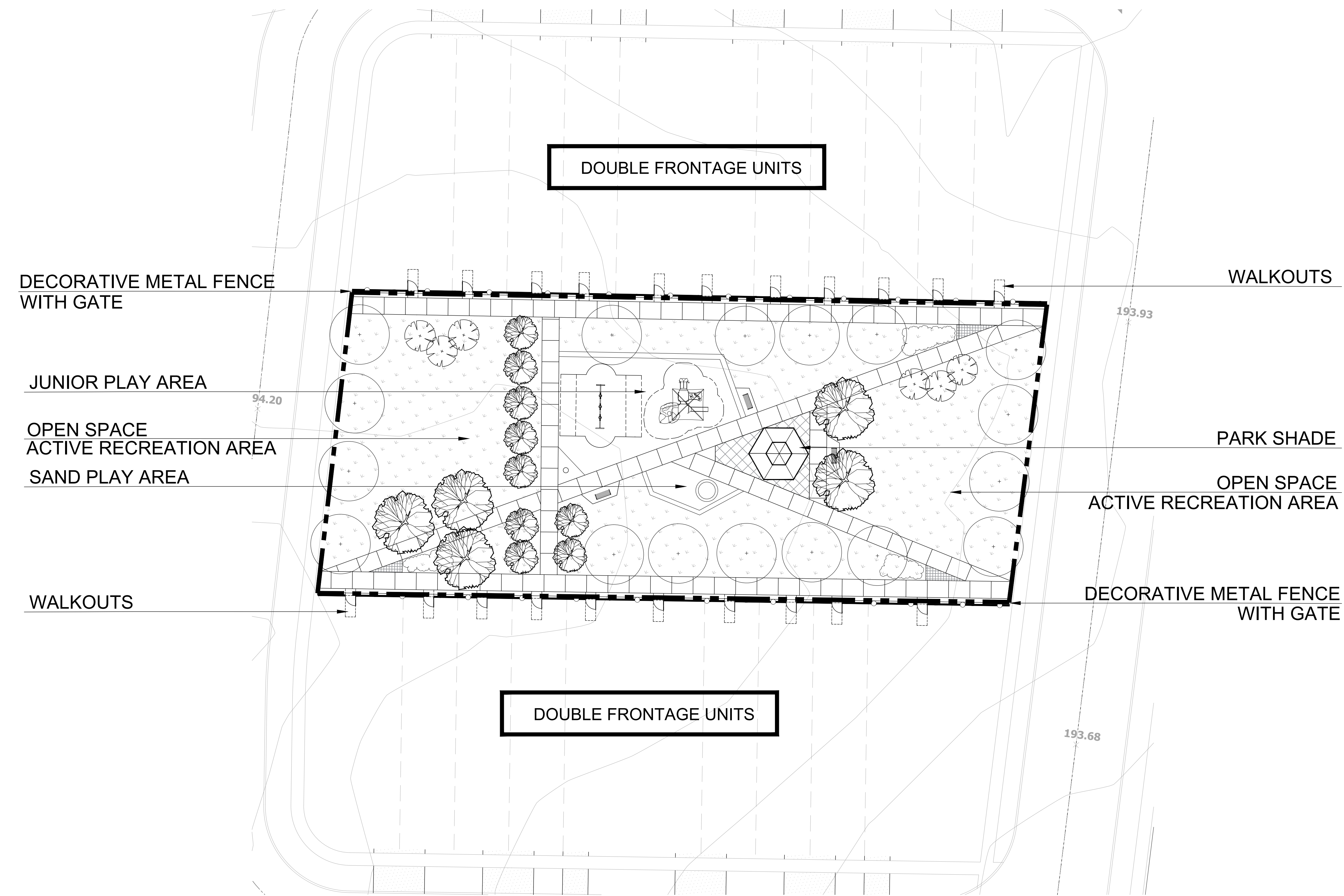

KEY MAP			
LEGEND:			
	LIMIT OF SUBDIVISION		
	DECORATIVE METAL FENCE WITH GATE		
	SODDING		
	PROPOSED DECIDUOUS TREES		

REVISIONS			
no.	revision	date	by
R0	ISSUED FOR FIRST SUBMISSION	20250327	CJ

THESE DRAWINGS ARE THE PROPERTY OF CGLA CONSULTANTS INC. AND SHALL NOT BE ALTERED, MODIFIED, REVISED OR CHANGED WITHOUT THE WRITTEN CONSENT OF CGLA CONSULTANTS INC. SEAL IS NOT VALID WITHOUT SIGNATURE OF THE LANDSCAPE ARCHITECT. DRAWINGS CANNOT BE USED FOR TENDER/CONSTRUCTION UNTIL SIGNED BY LANDSCAPE ARCHITECT.

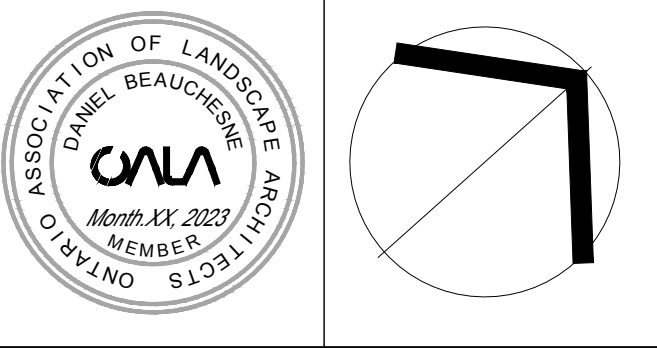

Client:  
FRONTENAC FOREST  
ESTATES INC.

TOWN OF MILTON

Project Title:  
FRONTENAC FOREST

Drawing Title:  
VILLAGE SQUARE 1  
FACILITY FIT

Reviewed: DB Drawn: CJ

Scale: 1:250 Date: 20250327

Project Number: 2813

Drawing Number  
P3



## VILLAGE SQUARE 1

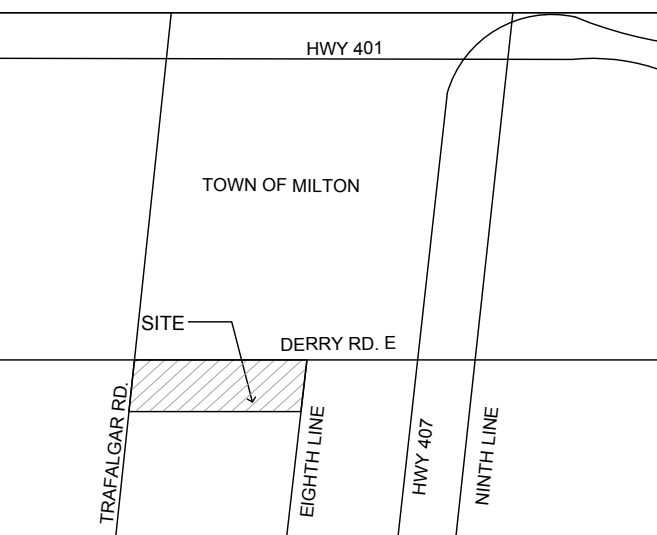
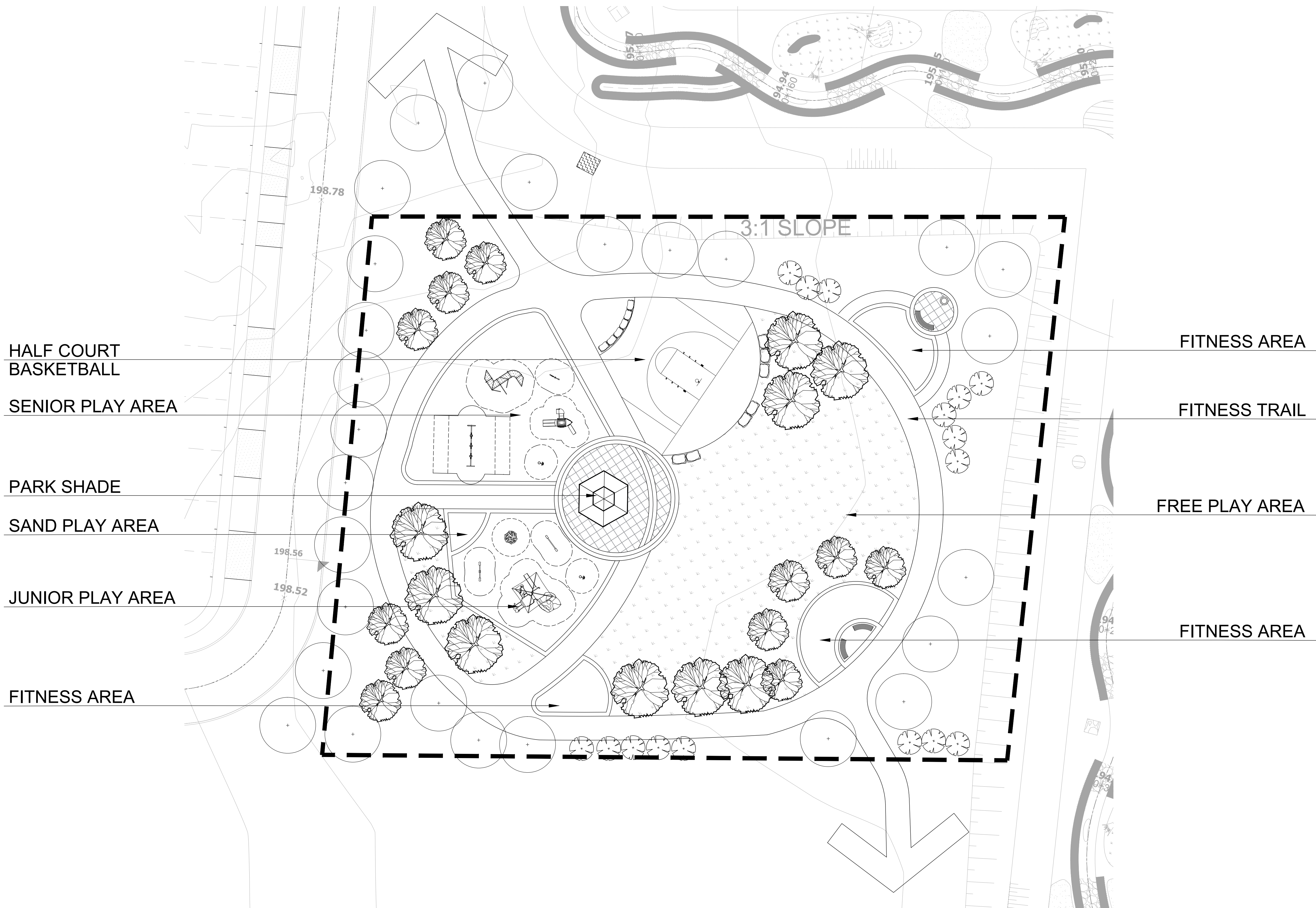

## KEY MAP

LEGEND:

- 

R0	ISSUED FOR FIRST SUBMISSION	20250327	CJ	
no.	revision	date	by	

THESE DRAWINGS ARE THE PROPERTY OF CGLA CONSULTANTS INC. AND SHALL NOT BE ALTERED, MODIFIED, REVISED OR CHANGED WITHOUT THE WRITTEN CONSENT OF CGLA CONSULTANTS INC. SEAL IS NOT VALID WITHOUT SIGNATURE OF THE LANDSCAPE ARCHITECT. DRAWINGS CANNOT BE USED FOR TENDER/CONSTRUCTION UNTIL SIGNED BY LANDSCAPE ARCHITECT.

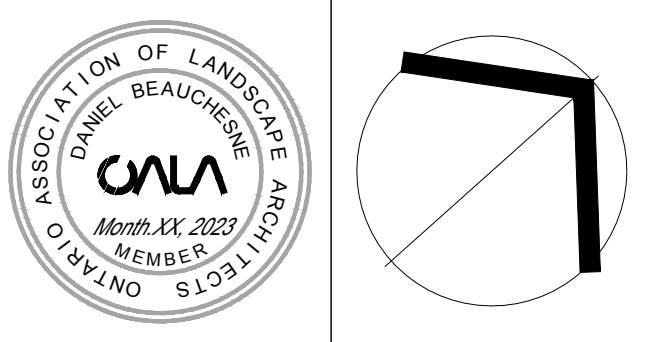

Client:  
FRONTENAC FOREST  
ESTATES INC.

TOWN OF MILTON

Project Title:  
**FRONTENAC FOREST**

Drawing Title:  
**PARK  
PRESERVATION  
LANDSCAPE PLAN**

Reviewed: DB	Drawn: CJ
Scale: 1:250	Date: 20250327
Project Number: 2813	
Drawing Number	

Drawing Number **P4**