

## EXISTING AGRICULTURAL LANDS

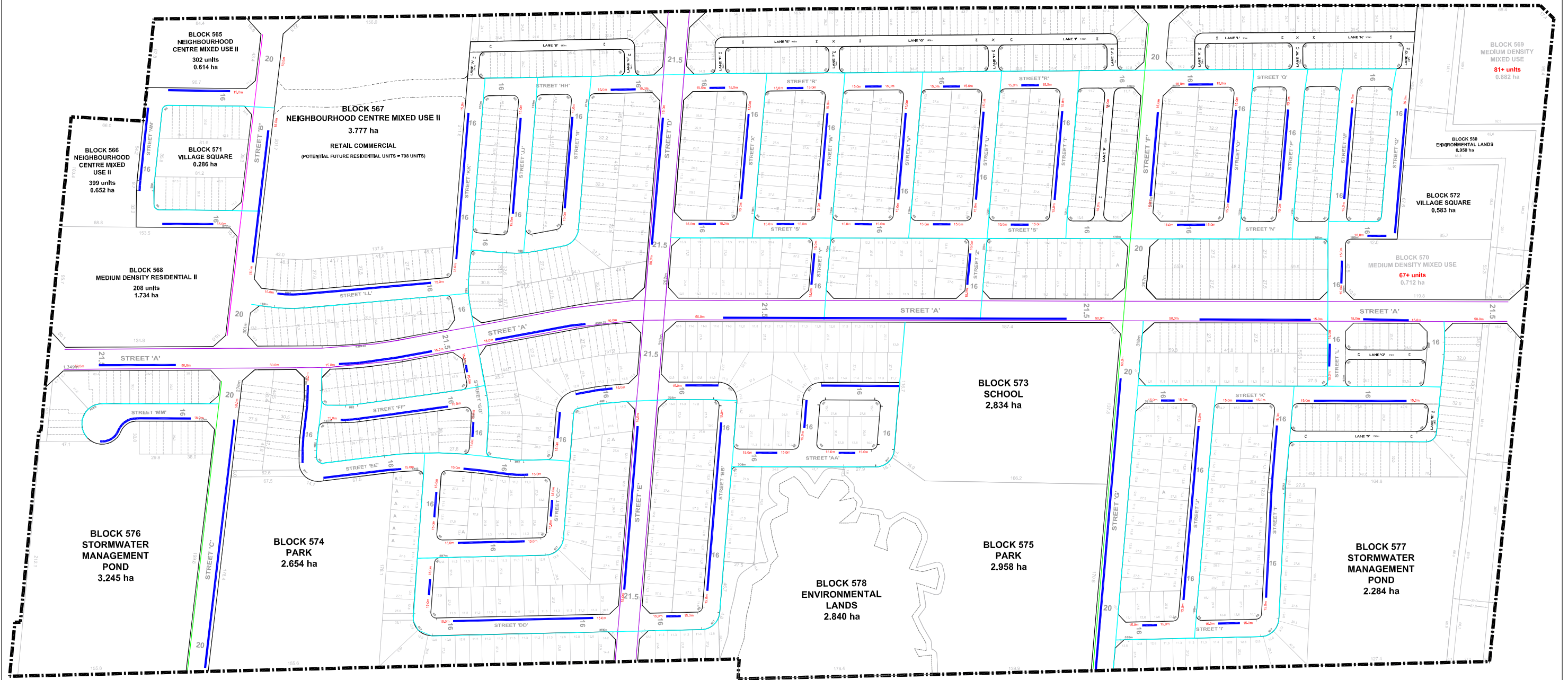

## EXISTING AGRICULTURAL LANDS (FUTURE DEVELOPMENT)

## EXISTING

- Note:  
On-street parallel parking locations are shown with the following parking prohibition rule as per Town of Milton Engineering and Parks Standards Manual & Town of Milton's Parking Regulation:
- Parking Prohibition Distances:
    - 15.0m parking prohibitions at local-to-local & local-to-collector intersecting roads
    - 50.0m parking prohibitions at collector-to-collector & collector-to-arterial intersecting roads
  - On-street parallel parking is placed on the opposite side of watermain lines. Final placement to be confirmed at the detailed design stage after the location of residential driveways and utilities is finalized.
  - On streets with bike lanes on both sides, no on-street parking is permitted.
  - On streets with a cycle track and multi-use path (MUP) on one side, on-street parking is only provided on the opposite side of the cycle track and MUP.
- Legend:  
On-Street Parallel Parking Locations  
Watermain Lines (from base plan)  
Bike Lane (Both Sides)  
Cycle Track (One Side)  
Multi-Use Path (One Side)