

SCHEDULE 'A'
TO BY-LAW No. 016 - 2014
TOWN OF MILTON
 PART OF LOT 10, CONCESSION 6, NEW SURVEY
 TOWN OF MILTON, REGIONAL MUNICIPALITY OF HALTON

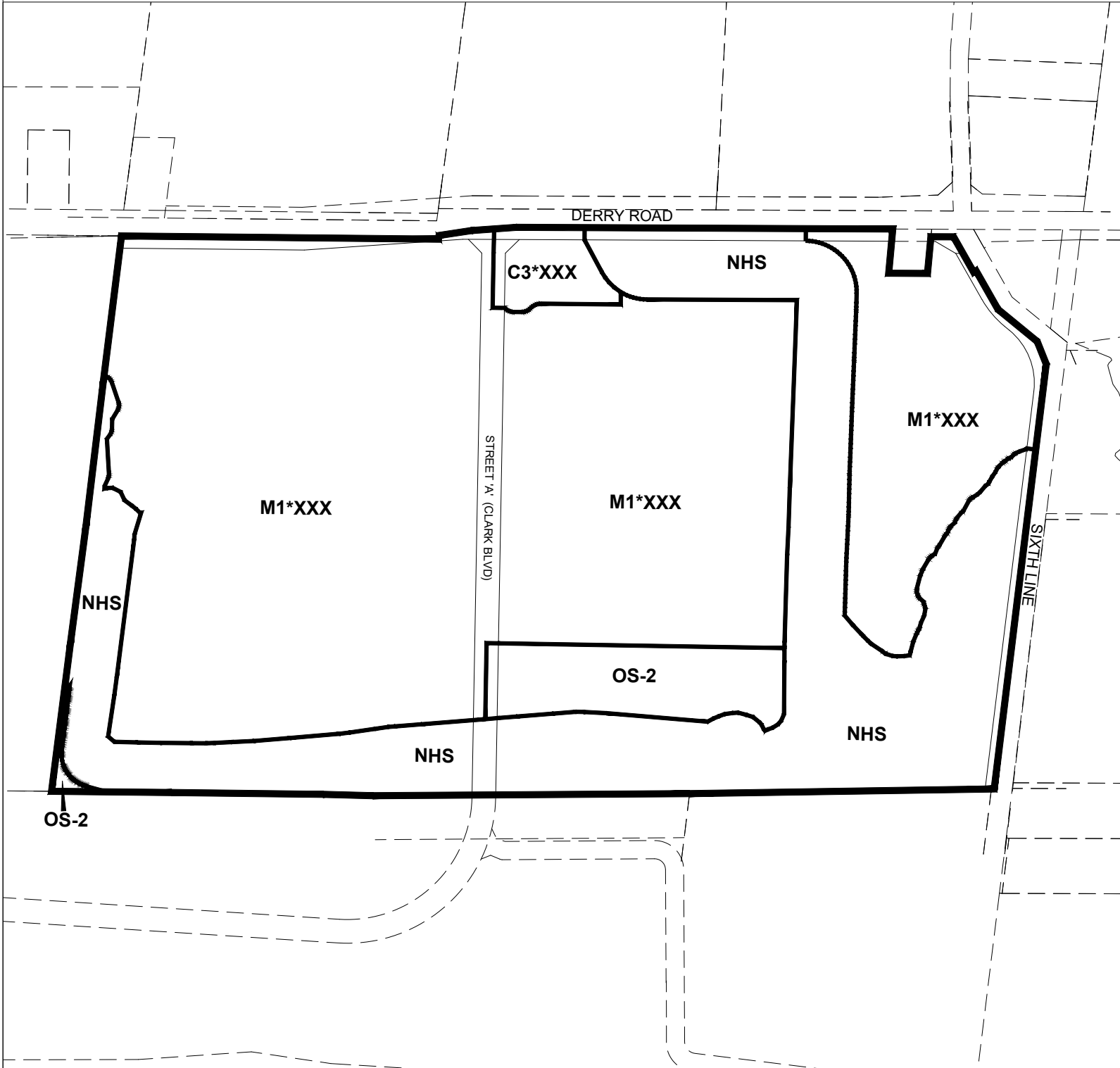

THIS IS SCHEDULE A
 TO BY-LAW No. 016 - 2014

 MAYOR

 CLERK

REZONED FROM GOLF COURSE ZONE (GC) AND
 NATURAL HERITAGE SYSTEM (NHS)

TO:

'M1*XXX' - BUSINESS PARK ZONE _____

'C3*XXX' - LOCAL COMMERCIAL ZONE _____

'NHS' - NATURAL HERITAGE SYSTEM

'OS-2' - OPEN SPACE - STORM WATER MANAGEMENT



SCALE: N.T.S.
 DECEMBER 5, 2023